

128g铜版纸单面 单色印刷 A4规格 单面

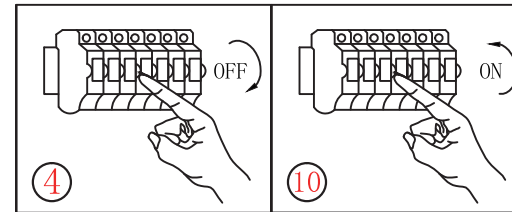

User's Manual



WARNING: ELECTRICAL SHOCK CAN RESULT IN SERIOUS INJURY.

Read and follow instructions exactly as shown.
Contact a qualified electrician. Read all instructions before beginning. Proper wiring is essential for safe operation of this fixture. When cutting or drilling into walls or ceilings, do not damage electrical wiring, gas lines, or water lines.
NOTE: For fixture employing a grounded convenience outlet. This fixture employs a grounded type receptacle and is not intended for connection to a two wire ungrounded source of supply.

PARAMETERS

Material Type: Metal
Voltage: AC 110V/60Hz
Max. Wattage: 60W (Each Lamp)
Bulb Type: E12 (Not Included)

MOUNTING, WIRING AND FIXTURE ASSEMBLY INSTRUCTIONS

1. Pass the wires which on the lampshade through two tubes, and twist the two tubes and the lampshade tightly. As shown ① and ② ③
2. Turn off the electricity supply before installation to avoid possible electric shock. As shown ④
3. Lock the cross bar on the junction box with screw. As shown ⑤
4. The wires which extended from the tube continues to pass through the canopy. Connect the outgoing wires from the fixture with electric wires from outlet box correctly. As shown ⑥
5. Position canopy over mounting screws which on the cross bar, aligning canopy openings with mounting screws, then secure with cap nuts. As shown ⑦
6. Fit four cylindrical tubes into each of the four lamp holder. As shown ⑧
7. Install E12 bulbs. Do NOT exceed recommended wattage. As shown ⑨
8. Turn on the electricity supply. As shown ⑩

